

Gosford Aquifier (Pre 2009)

abode

General Advice:

- These instructions are intended as a guide only, if you are in any doubt you should seek the advice of a qualified professional.
- Take care not to mark finished parts with screwdrivers or other tools.
- Use a pair of rubber gloves to get a better grip on decorative hand tight parts.
- Ensure all parts are reassembled tightly.
- After maintenance test that all assemblies are water tight and function correctly.
- Always isolate the hot and cold water supplies before starting any maintenance, once isolated you should drain any residual water from your system.

To replace the hot valve:

1. Using a small flat screwdriver lever dust cap (D5) away from the lever (D3).
2. Pull the handle (D3) horizontally away from the tap body (B1).
3. Unscrew the decorative valve cover (D2)
4. Unscrew the valve (D1) using a 17mm ring spanner or adjustable wrench.
5. Clean any debris from the chamber in the tap body (B1).
6. Reassemble the tap in the reverse order.

To replace the cold/filter valve:

1. Using a small flat screwdriver lever dust cap (C8) away from the lever (C6).
2. Remove screw (C7).
3. Pull the handle (C6) horizontally away from the body (B1).
4. Unscrew the decorative cover (C4) anticlockwise.
5. Unscrew the valve bush (C3) using a 17mm ring spanner or adjustable wrench.
6. Pull the valve bushes (C2 & C3) away from the tap body (B1)
7. If required remove the o-rings by separating parts (C2 & C3) by pushing down on the thin top part of part (C2) whilst holding the outside of part (C3).
8. Pull the old Aquifier valve cartridge (C1) away from the tap body (B1) and ensure all parts of the valve including the red seal are removed.
9. Clean any debris from the chamber in the tap body (B1).
10. Place the brass cover (C2) on the valve (C1)
11. Place the new Aquifier valve (C1) and valve cover (C2) into the chamber (B1) **ensuring that the pegs on the base of the valve (C1) match up with those in the tap chamber (B1).**
12. Whilst holding the valve in place pass the valve bush (C3) over (C1 & C2) and tighten using a 17mm ring spanner.

To replace the spout o-rings:

1. Loosen grub screw (A8) on the rear of body (B1) using a small flathead screwdriver.
2. Pull the spout (A4) vertically away from the body (B1).
3. Remove the old o-rings (A6 & A7) using a small screwdriver or similar.
4. If worn, remove the white PTFE spacer (A5).
5. Ensure the inside of the body (B1) and the spout base is clean of dirt and grit with a soft wet cloth.
6. If required locate the new white PTFE spacer (A5).
7. Carefully locate the new O-rings (A6 & A7) onto the spout base (A4).
8. Grease the O-rings thoroughly with silicone or alternative similar grease.
9. Reassemble the tap in the reverse order.

To replace the hot indice:

1. Unscrew the indice collar (D7).
2. Push the indice (D8) out from the indice collar (D7).
3. Screw the indice collar (D7) into the handle lever (D6).
4. Push the indice (D8) into the indice collar (D7).

Note. For previous versions of the tap use a small flat precision screwdriver to lever out the old indice (D8) from the handle lever (D6) then push in the new indice (D8).

Gosford Aquifer (2009 Onwards)

abode

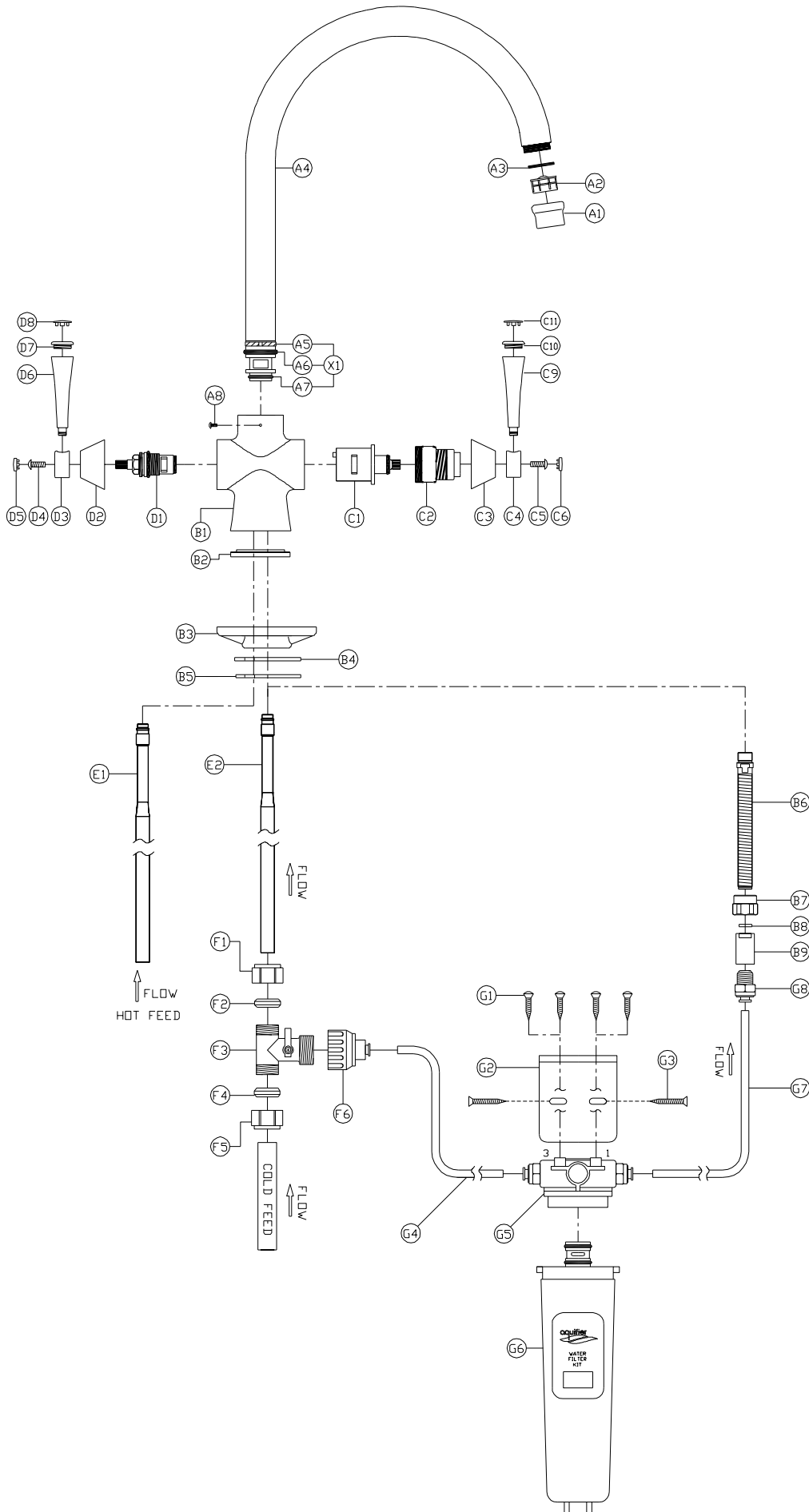

Gosford Aquifer (2009 Onwards)

abode

General Advice:

- These instructions are intended as a guide only, if you are in any doubt you should seek the advice of a qualified professional.
- Take care not to mark finished parts with screwdrivers or other tools.
- Use a pair of rubber gloves to get a better grip on decorative hand tight parts.
- Ensure all parts are reassembled tightly.
- After maintenance test that all assemblies are water tight and function correctly.
- Always isolate the hot and cold water supplies before starting any maintenance, once isolated you should drain any residual water from your system.

To replace the hot valve:

7. Using a small flat screwdriver lever dust cap (D5) away from the lever (D3).
8. Pull the handle (D3) horizontally away from the tap body (B1).
9. Unscrew the decorative valve cover (D2)
10. Unscrew the valve (D1) using a 17mm ring spanner or adjustable wrench.
11. Clean any debris from the chamber in the tap body (B1).
12. Reassemble the tap in the reverse order.

To replace the cold/filter valve:

13. Using a small flat screwdriver lever dust cap (C7) away from the lever (C5).
14. Remove screw (C6).
15. Pull the handle (C5) horizontally away from the body (B1).
16. Unscrew the decorative cover (C3) anticlockwise.
17. Unscrew the valve bush (C2) using a 17mm a pair of mole grips.
18. Pull the old Aquifer valve cartridge (C1) away from the tap body (B1).
19. Clean any debris from the chamber in the tap body (B1).
20. Place the new Aquifer valve (C1) into the chamber (B1) **ensuring that the peg on the base of the valve (C1) matches up with that of the tap chamber (B1).**
21. Reassemble in reverse order.

To replace the spout o-rings:

10. Loosen grub screw (A8) on the rear of body (B1) using a small flathead screwdriver.
11. Pull the spout (A4) vertically away from the body (B1).
12. Remove the old o-rings (A6 & A7) using a small screwdriver or similar.
13. If worn, remove the white PTFE spacer (A5).
14. Ensure the inside of the body (B1) and the spout base is clean of dirt and grit with a soft wet cloth.
15. If required locate the new white PTFE spacer (A5).
16. Carefully locate the new O-rings (A6 & A7) onto the spout base (A4).
17. Grease the O-rings thoroughly with silicone or alternative similar grease.
18. Reassemble the tap in the reverse order.

To replace the hot indice:

5. Unscrew the indice collar (D7).
6. Push the indice (D8) out from the indice collar (D7).
7. Screw the indice collar (D7) into the handle lever (D6).
8. Push the indice (D8) into the indice collar (D7).

Note. For previous versions of the tap use a small flat precision screwdriver to lever out the old indice (D8) from the handle lever (D6) then push in the new indice (D8).

Gosford Aquifer (2013 Onwards)

abode

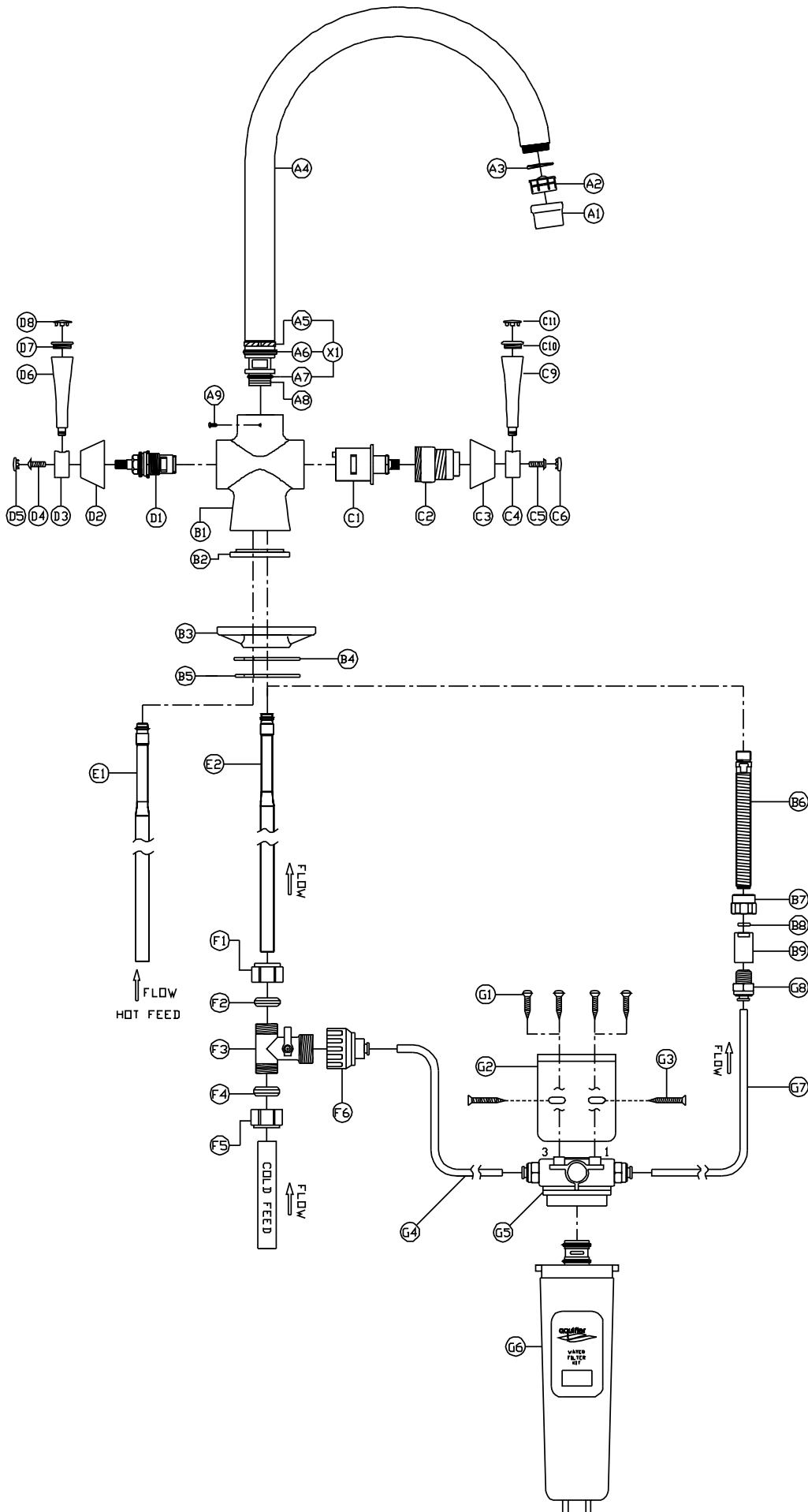

Gosford Aquifier (2013 Onwards)

General Advice:

- These instructions are intended as a guide only, if you are in any doubt you should seek the advice of a qualified professional.
- Take care not to mark finished parts with screwdrivers or other tools.
- Use a pair of rubber gloves to get a better grip on decorative hand tight parts.
- Ensure all parts are reassembled tightly.
- After maintenance test that all assemblies are water tight and function correctly.
- Always isolate the hot and cold water supplies before starting any maintenance, once isolated you should drain any residual water from your system.

To replace the hot valve:

13. Using a small flat screwdriver lever dust cap (D5) away from the lever (D3).
14. Pull the handle (D3) horizontally away from the tap body (B1).
15. Unscrew the decorative valve cover (D2)
16. Unscrew the valve (D1) using a 17mm ring spanner or adjustable wrench.
17. Clean any debris from the chamber in the tap body (B1).
18. Reassemble the tap in the reverse order.

To replace the cold/filter valve:

22. Using a small flat screwdriver lever dust cap (C7) away from the lever (C5).
23. Remove screw (C6).
24. Pull the handle (C5) horizontally away from the body (B1).
25. Unscrew the decorative cover (C3) anticlockwise.
26. Unscrew the valve bush (C2) using a 17mm pair of mole grips.
27. Pull the old Aquifier valve cartridge (C1) away from the tap body (B1).
28. Clean any debris from the chamber in the tap body (B1).
29. Place the new Aquifier valve (C1) into the chamber (B1) **ensuring that the peg on the base of the valve (C1) matches up with that of the tap chamber (B1).**
30. Reassemble in reverse order.

To replace the spout o-rings:

19. Loosen grub screw (A9) on the rear of body (B1) using a small flathead screwdriver.
20. Pull the spout (A4) vertically away from the body (B1).
21. Remove the old o-rings (A6 & A7) using a small screwdriver or similar.
22. If worn, remove the white PTFE spacer (A5 & A8).
23. Ensure the inside of the body (B1) and the spout base is clean of dirt and grit with a soft wet cloth.
24. If required locate the new white PTFE spacer (A5 & A8).
25. Carefully locate the new O-rings (A6 & A7) onto the spout base (A4).
26. Grease the O-rings thoroughly with silicone or alternative similar grease.
27. Reassemble the tap in the reverse order.

To replace the hot indice:

9. Unscrew the indice collar (D7).
10. Push the indice (D8) out from the indice collar (D7).
11. Screw the indice collar (D7) into the handle lever (D6).
12. Push the indice (D8) into the indice collar (D7).

Note. For previous versions of the tap use a small flat precision screwdriver to lever out the old indice (D8) from the handle lever (D6) then push in the new indice (D8).